

WALLFLORE®PER-e

Greening rainscreen cladding system for external elevations

WALLFLORE®PER-e is a unique wall greening cladding system using the modern modular technology of a ventilated rainscreen system.

The **WALLFLORE®PER-e** system has been designed to allow the greening of all types of elevations and buildings, including all types of openings, with a wide range of panel's dimensions. The **Exin** version allows for an external insulation layer.

The **WALLFLORE®PER-e** system is therefore an alternative, as well as the ideal complement, to other classical cladding systems such as:

- mineral (stone, brick, ceramic granite, terracotta, etc)
- metallic (aluminium, SS, zinc, Copper, etc)
- synthetic (composite panels, PVC, etc)
- timber (panels, boards, etc)
- photovoltaic (solar panels).

The **WALLFLORE®PER-e** system is the first system to meet the requirements of H92 rainscreen specification clause, and can also be used as a purely decorative cladding.

Beside its unique aesthetic, the **WALLFLORE®PER-e** system brings further added values not available with other classical cladding systems:

- The circulation of water combined with the plants natural respiration add a dynamic solar shading factor and increase the energy management function of the cladding system, reducing the need for air conditioning in summer time ;
- The natural change of colours of the foliage and flowers through the year brings life to your building.



WALLFLORE®PER-i 4 unique selling points

1- Low installation costs

Light weight modular panels, easy to install, similar to current techniques of modern partitioning systems.

2- Environmentally friendly

Components of the panels and the support system use materials that are 100% recyclable or recycled. Rainwater recycling. Meet the specification of passive building.

3- Low running costs and maintenance costs

The built-in irrigation system allows for the use of recycled water, and can be remotely-controlled. The irrigation drippers can be easily replaced without removing any panels.

4- 10 year guaranty + insurance

The aluminum system comes with a manufacturer's guaranty and an insurance-backed guaranty of 10 years.

Technical datasheet WALLFLORE® PER-e

Standard panel dimensions mm (WxH)

600 x 1000 / 600 x 750 / 600 x 500 / 600 x 250
300 x 1000 / 300 x 750 / 300 x 500 / 300 x 250
Cut sizes available upon request.

Panel's thickness (excluding support system and plants) With or without external insulation:
75 mm

Panels' weight

Based on 600 x 1000 mm panels: 12 to 15 kg
i.e. 20 to 25 kg per m²

Components

Growing Substrate

SAINT-GOBAIN/CULTILENE horticultural stone wool (80 kg/m³) with a lifetime greater than 5 years, and 100% recyclable at end-of-life.

Panel Structure

Invisible structure made of Aluminium 5083 (AG5).

Envelope

Non-woven felt made of recycled PP and PE, treated anti-UV. Colour : dark grey (RAL 9011).
guaranty of 5 years

Support system

Proprietary brackets, vertical and horizontal rails (aluminium 5083). Fitting of the panels from the front.

Irrigation system

The proprietary built-in network of irrigation drippers in the support system's rails brings to the plants the precise amount of nutrients and water. The irrigation is fully automated and remotely controlled via an irrigation station, typically located in the plant room of the building.

Plants

Perennial plants adapted to the local climate and elevation for each project. (standard range of 18 species).

Plants density : 16 plants per panel
600 x 1000 mm (27 plants per m²).

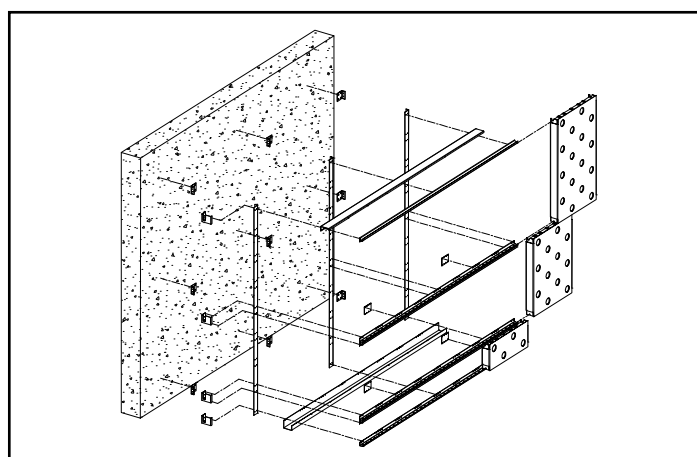
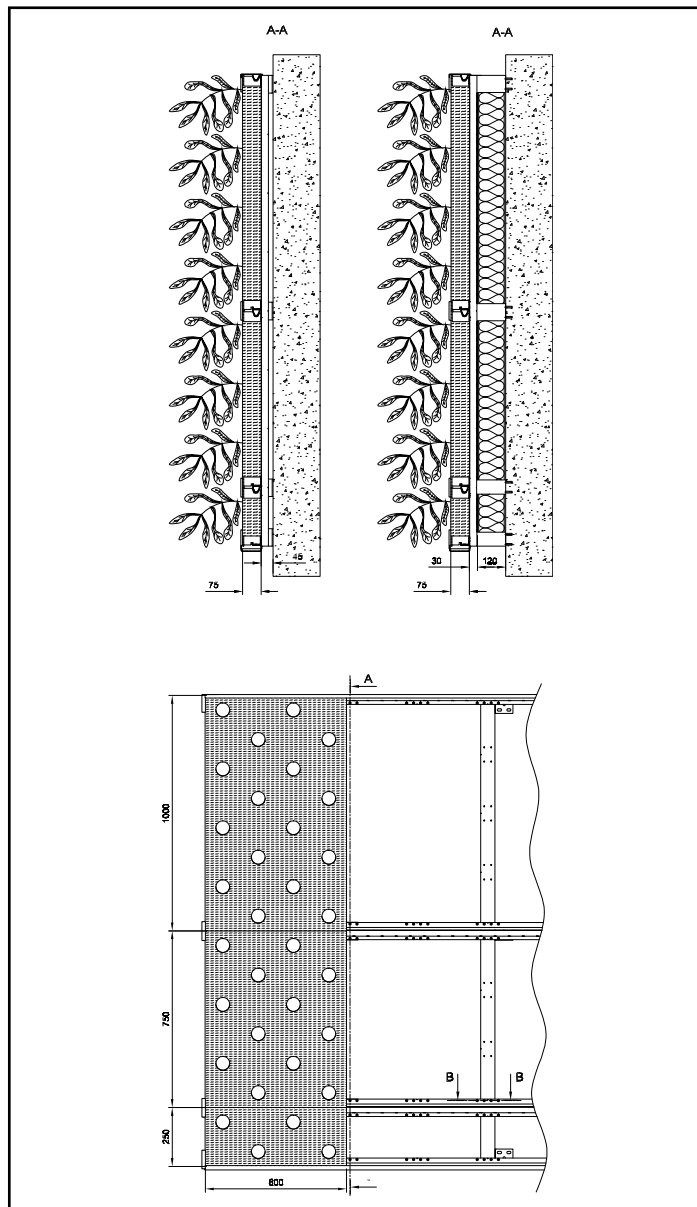

WALLFLORE® SYSTEMS N.V.

Raadhuisplein 41

5121 JZ Rijen

The Netherlands

+31(0)161 22 89 55

+31(0)161 22 89 50

info@wallflore.eu

www.wallflore.com